

1141 E. Main Street, Unit 107  
East Dundee, IL  
2,654 SQFT

**Option 1 – Existing Layout**

+/- 1,900 SQFT Office with 4 Private Offices  
+/- 750 SQFT Warehouse Area

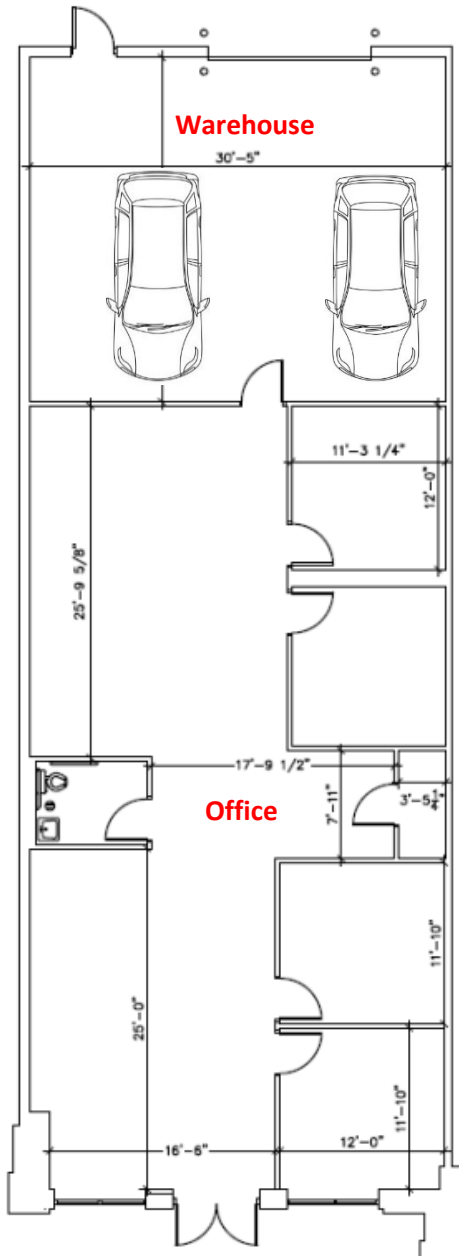

**12' x 14' Drive-In Garage Door**  
**Park Inside During the Winter!**

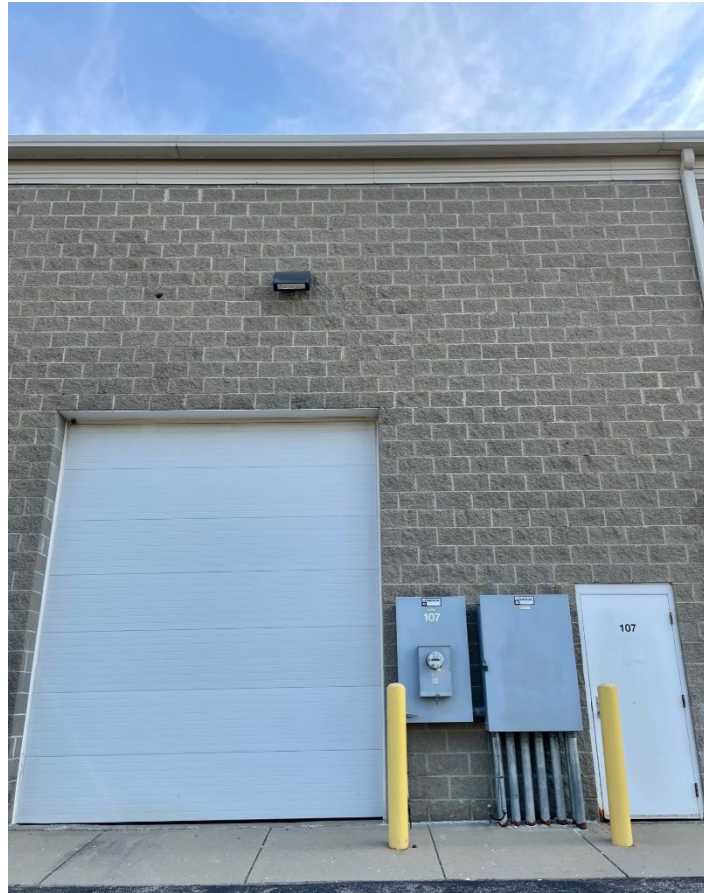

**Option 2 – Larger Warehouse Area**

+/- 1,500 SQFT Office with 3 Private Offices  
+/- 1,140 SQFT Warehouse Area 38' deep x 30' wide

